

In the Box

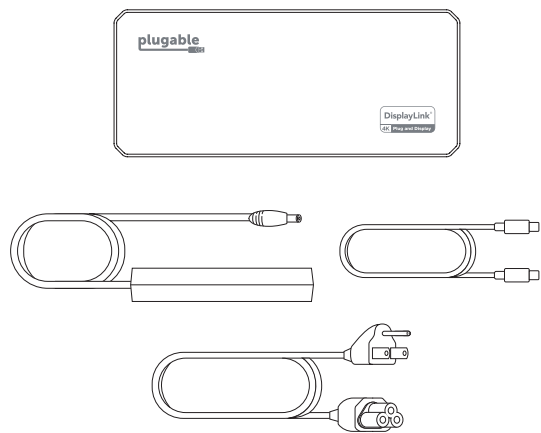

Questions? We're here to help!

plugable.com/products/ud-6950pdz

support@plugable.com

ご質問は下記へご連絡ください。 nihongo@plugable.com

plugable.com/ja/products/ud-6950pdz

© 2020 Plugable Technologies | July 29th, 2020



UD-6950PDZ DOCKING STATION

Quick Start Guide

Guía de inicio rápido | Guide de démarrage rapide |
Guida introduttiva | Kurzanleitung | クイック・スタート・ガイド

Thank you for your purchase of the Plugable UD-6950PDZ Docking Station!

The Plugable UD-6950PDZ Docking Station connects to a supported system using the included USB-C cable and provides the ability to connect up to three additional 4K HDMI or DisplayPort displays, provide up to 60W of USB-C Power Delivery, six additional USB 3.0 ports, a wired Gigabit Ethernet port, and 3.5mm combination analog audio input/output jack.

1. Download and install driver.

Descargar e instalar el controlador.
Télécharger et installer le pilote.
Scarica e installa il driver.
Treiber herunterladen und installieren.
ドライバをダウンロードし、インストールします。

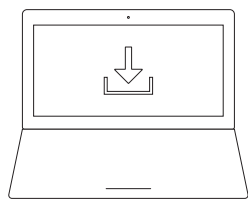

plugable.com/products/ud-6950pdz

2. Connect to power.

Enchufar a la corriente.
Brancher sur l'électricité.
Connetti all'alimentazione.
An ein Stromnetz anschließen.
電源を接続します。

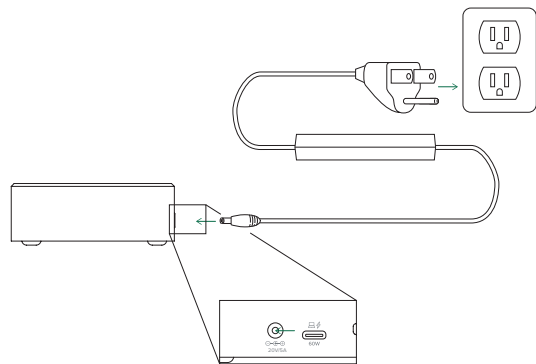

3. Connect the dock to host.

Conectar la base al servidor.
Connecter le dock à l'hôte.
Collega il dock all'host.
Dock mit dem Host verbinden.
ドッキングステーションをシステムに接続します。

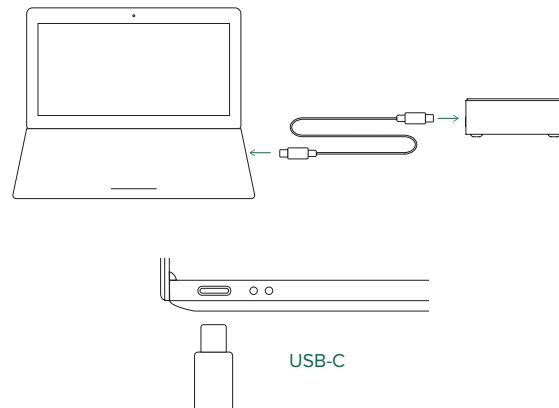

4. Connect peripherals.

Conectar los periféricos.
Connecter des périphériques.
Collega le periferiche.
Andere Geräte anschließen.
周辺機器を接続します。

